

Foundation Spore and Publix

BERLIN

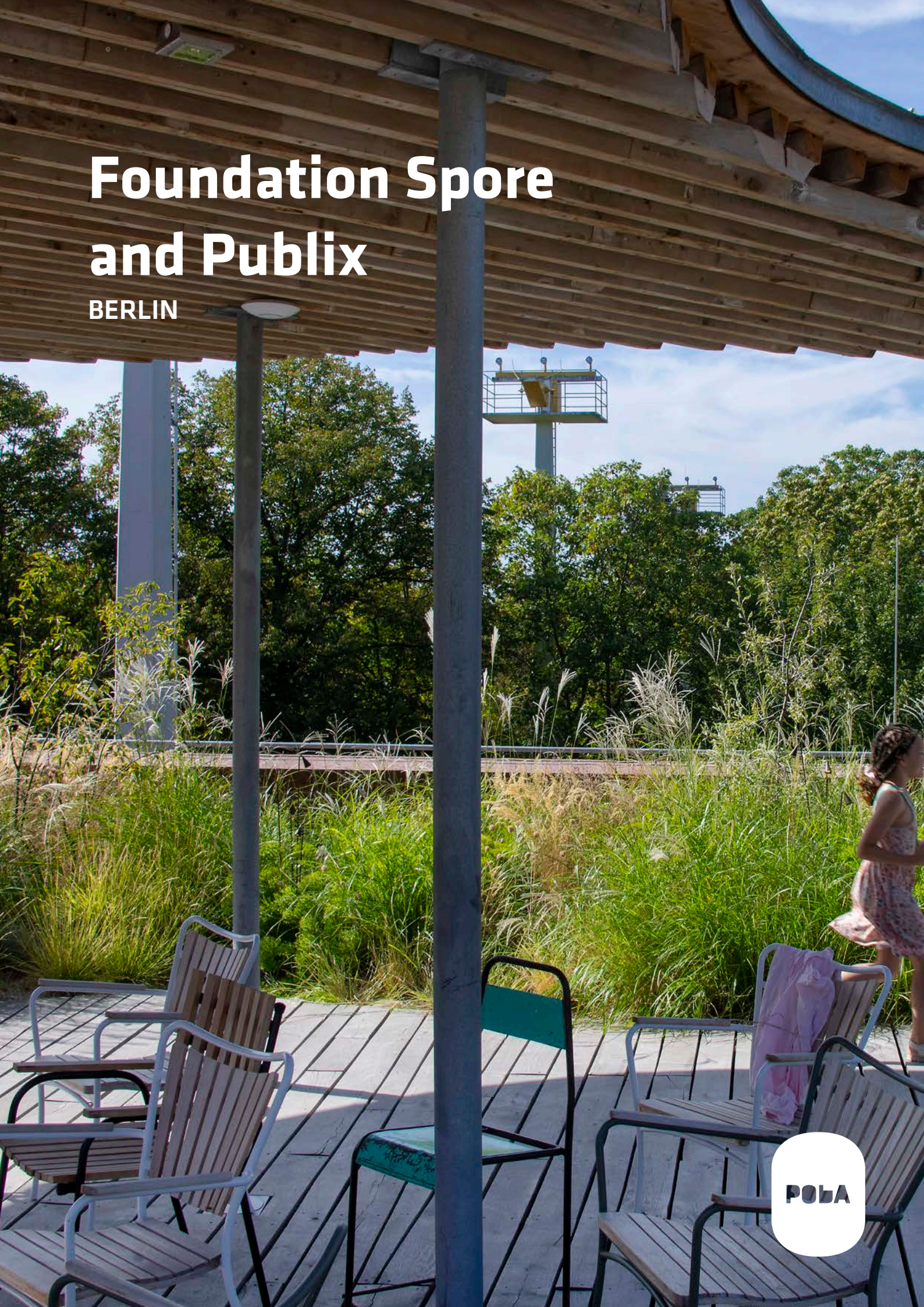

Loud asphalt. Rap music blends with the scent of sucuk. between the airport and the neighbourhood, brick and concrete. The gate to the cemetery, wedged between two houses. Quite modern here, all things considered. The rooftop terrace is supposed to be beautiful – at least, that's what I've heard – but it lives up there, and I am always down below. Now, between the raised bed and Frau Schwarz's final resting place, tending a garden caught between the living and the dead. I could get used to this. My iPhone trembles. Stefan's calling. I've got to go.

Foundation Spore and Publix

The Hermannstraße in Berlin-Neukölln shows no mercy: noise, density, social pressure, no greenery, nowhere to rest. The ensemble of Spore Initiative and Haus Publix responds not with enclosure but with openness – a permeable place that gives something back to the neighbourhood: no fence, no gesture of exclusion.

The former cemetery gate stands once again in its place, between the two buildings. The cemetery's avenue, buried under asphalt for decades, has been uncovered and restored. Bones discovered during excavation were transferred with dignity; existing graves were not removed but deliberately incorporated into the design. History is not overwritten here – it is carried forward.

The material strategy follows a single premise: what already exists takes precedence over the new. Brick from demolition, paving stone from other construction sites, seating cast from concrete waste generated on site – transformed, not merely recycled. Not old made new, but old made otherwise. The same logic extends to the weather canopy, clad with formwork timber from the interior fit-out – wood completing a second life, visibly. Sustainability here is not a promise but a reality: the discipline of drawing out what is essential from what is already there.

Above, on the roof, a landscape of its own: raw oak boards straight from the sawmill, interspersed with grasses and perennials native to the Brandenburg-Märkisch countryside – drought-tolerant, low-maintenance, deliberately wild.

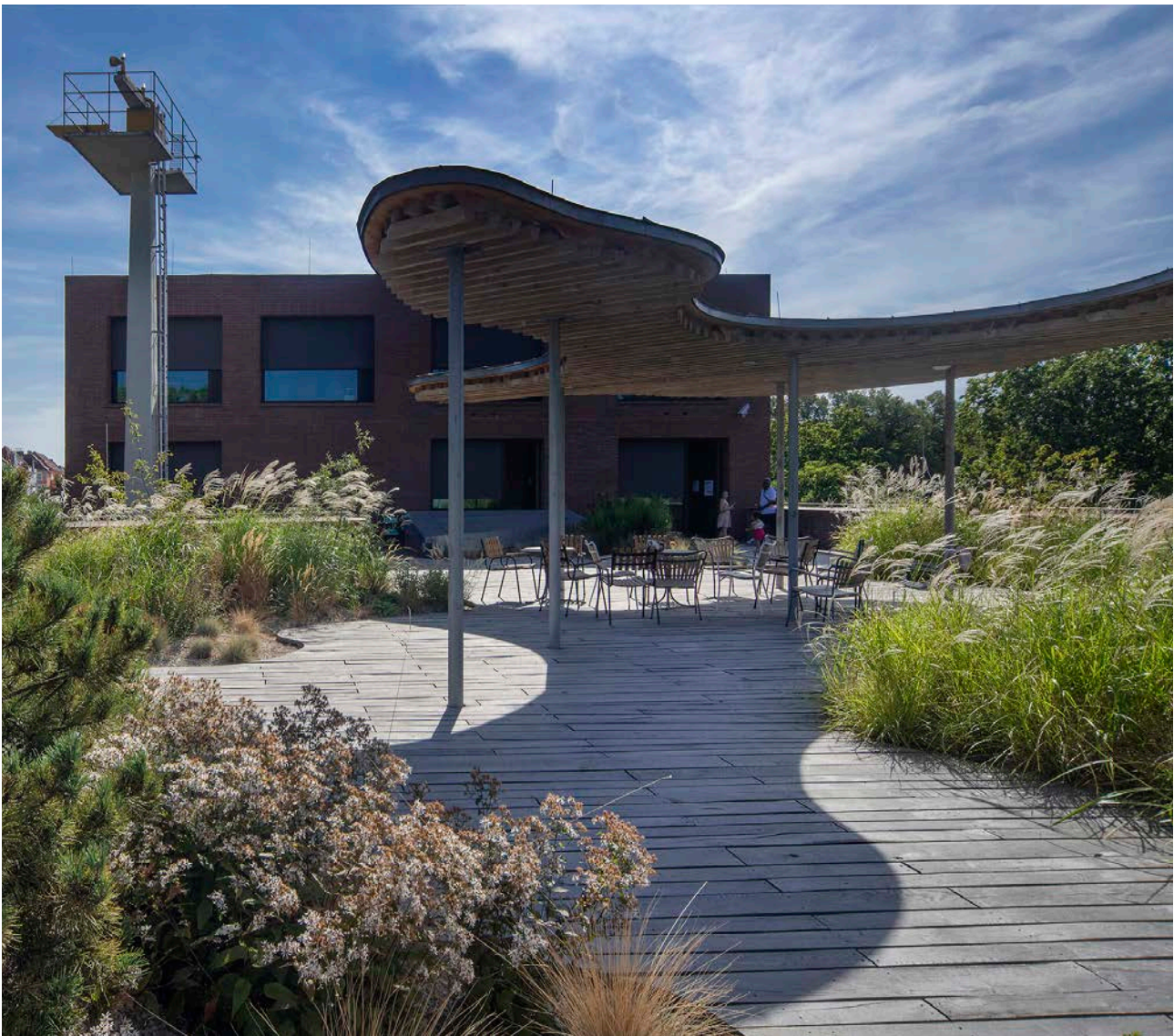



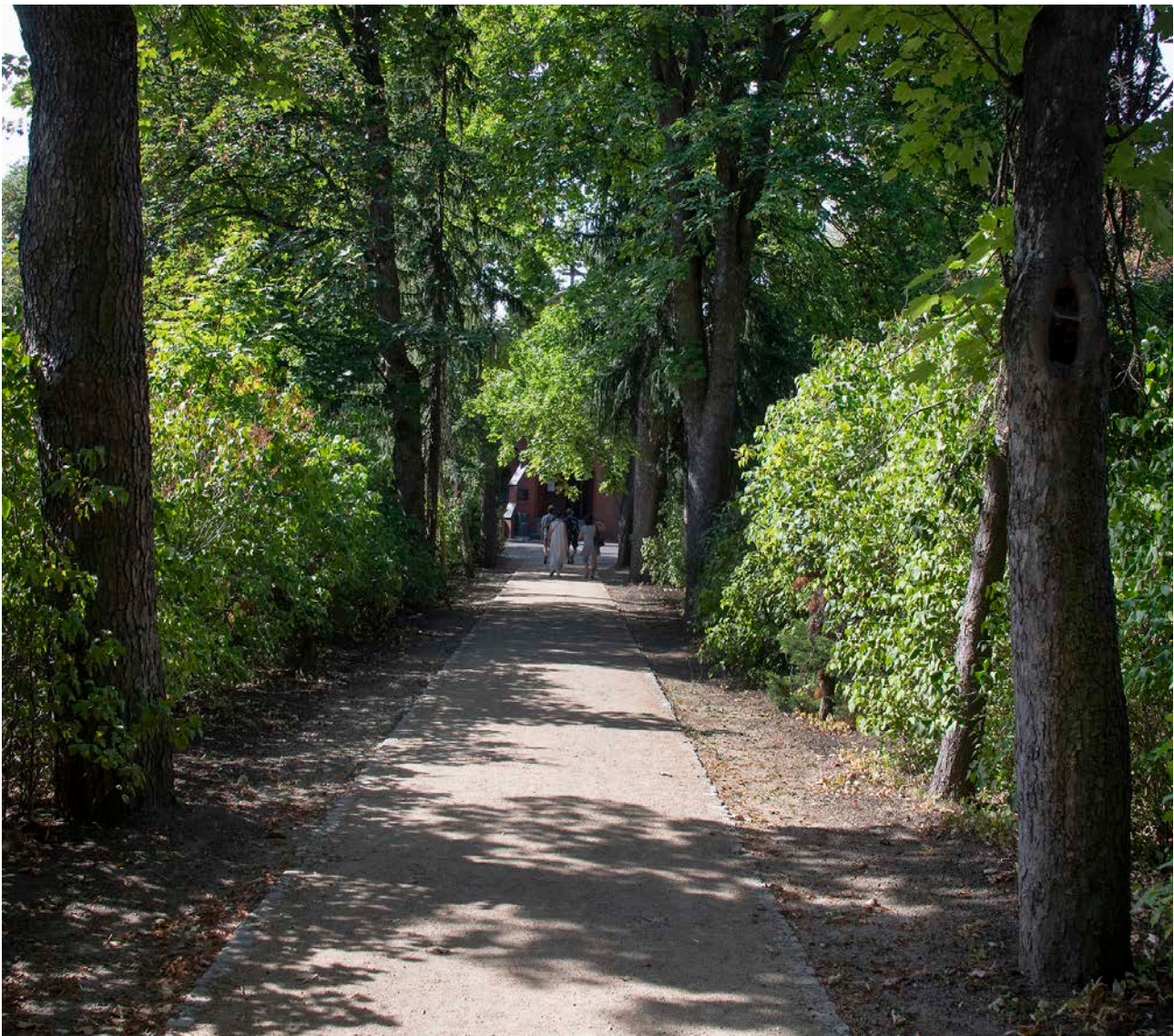





Projectdata **Foundation Spore initiative and Publix**

Project Spore Initiative

Location Berlin, GER

Client Schöpflin Foundation

Planning period 2019-2021

Construction period 2021-2023

Completion 2023

Services Planning and construction management (phases 1-9)

Size 1.000 m²

Costs 470.000 € net

Images Hanns Joosten

Project Publix

Location Berlin, GER

Client Schöpflin Foundation

Planning period 2020-2022

Construction period 2023-2024

Completion 2024

Services Planning and construction management (phases 1-9)

Size m²

Costs 680.000 € net

Images Hanns Joosten

POLA

POLA Landschaftsarchitekten GmbH

Neue Schönhauser Str. 16
10178 Berlin

T +49 (0)30-240 00 99-10

F +49 (0)30-240 00 99-11

Hongkongstr. 7

20457 Hamburg

T +49 (0)40-807 92 12-55

F +49 (0)40-807 92 12-15

mail@pola-berlin.de

www.pola-berlin.de

Press inquiries: pr@pola-berlin.de