

City Balcony

HANGZHOU, CHINA



POBA

*The Silver Dragon
is what they call the tidal bore
which looks harmless
from the height of the park
balcony above the waters of the
Qiantang, but man's superiority
over the power of nature is a
misconception.*

*Land hovering over the water,
sublime with a view of the silver
light, heavy as lead, exalted.
Confident but awestruck
they are watching from above
the dragon's foamy body
dashing up the river.*

The majestic Qiantang River is one of the main attractions of the city of Hangzhou. Yet it was only systematically integrated into the urban context in 2009 in order to utilise its potential for leisure, culture and commerce: the 'Culture Wave City,' an 800-metre-long structure, serves as a link between the 'Citizen Center' mall and the river bank. Meandering paths made out of wood and stone combined with belts of vegetation and water create patterns that connect the different levels of the buildings to create an ensemble complete with ramps and steps in the interplay of light and shadow. The architecture becomes one with the landscape, the artificial becomes one with the natural.

This green structure ends in a park-like esplanade which has been created on top of a 500-metre-wide block of buildings sitting on stilts in the Qiantang river. Over 1,000 newly planted trees, standing in rows and groups of camphor trees, southern magnolias and conifers, almost make visitors forget they're strolling on a man-made edifice.

The structure of this landscaped esplanade is an effigy of the river and its play with the tides. In reference to the famous tidal bore which transforms the Qiantang river once every year, to be witnessed from the safety of the balcony, the pattern of the new esplanade alludes to the washout of natural surfaces after a wave has retreated back to the sea.



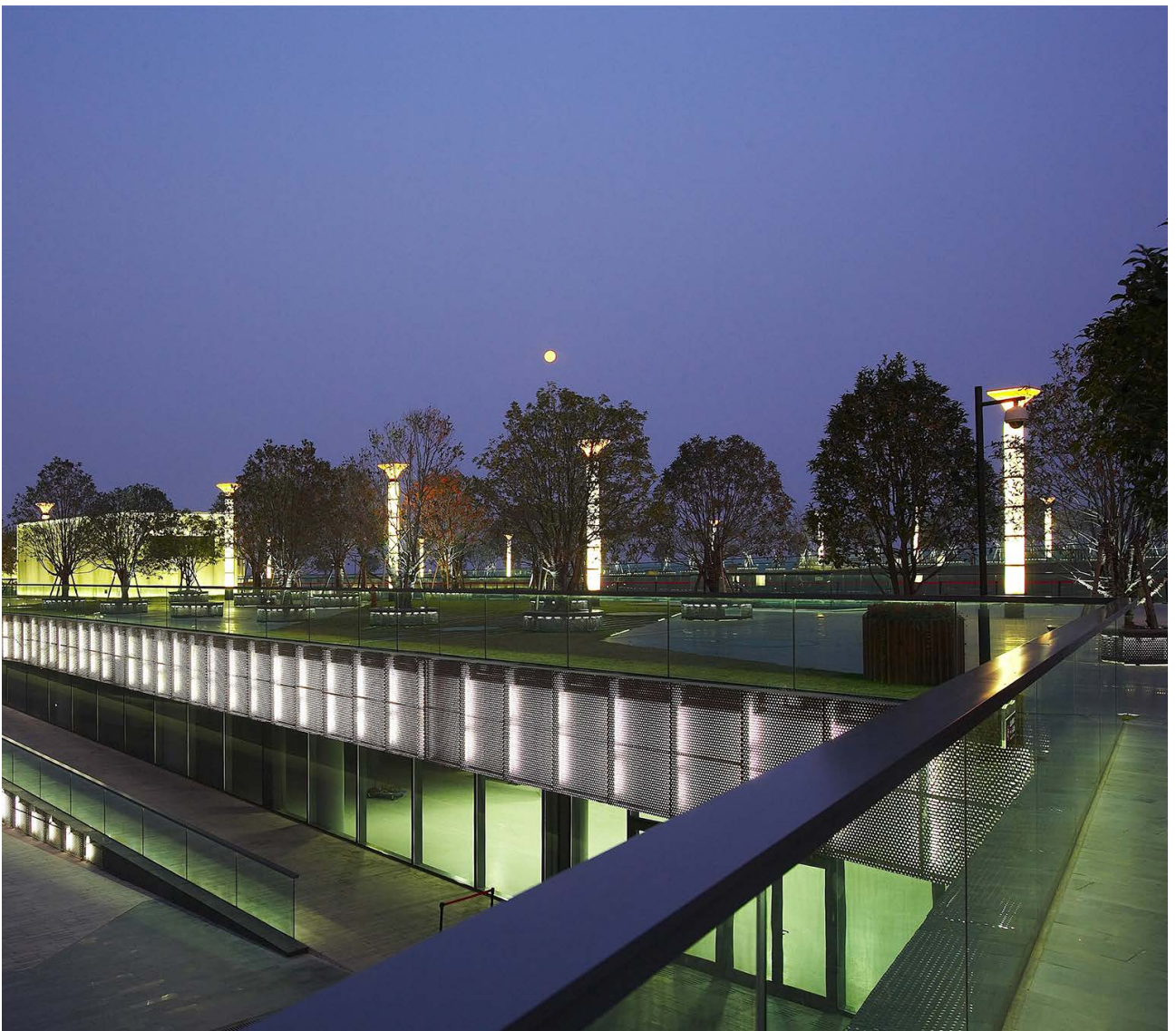
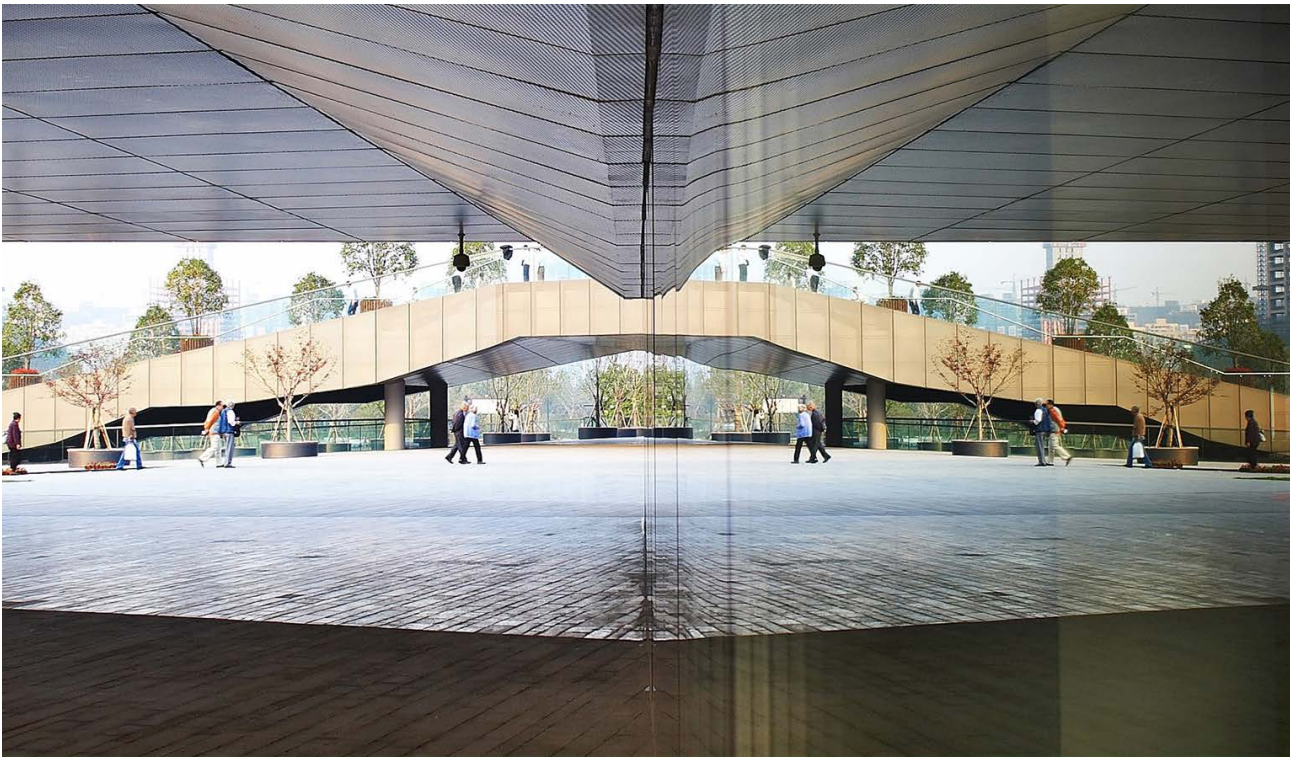

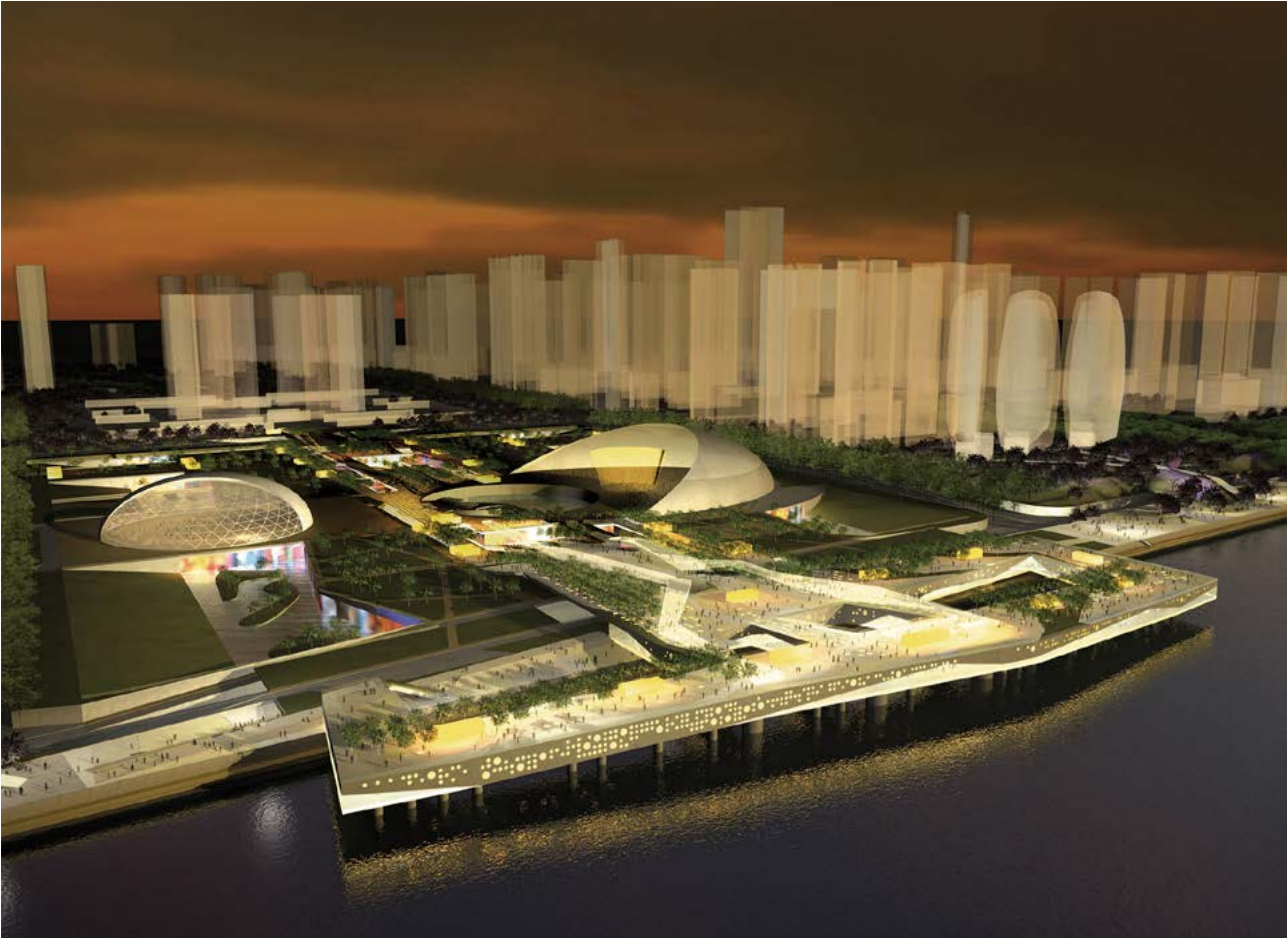

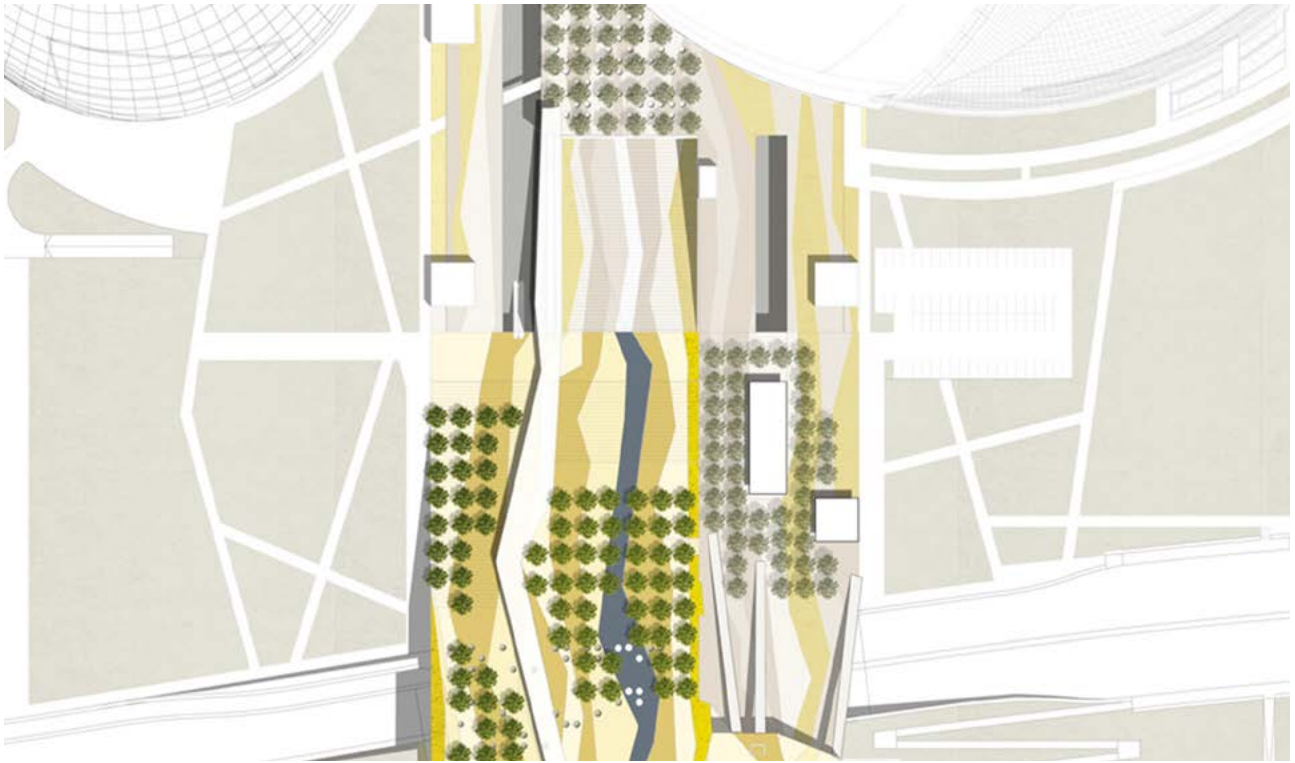

Project data

Project Hangzhou City Balkony

Location Hangzhou, CHN

Client Hangzhou Qiangjing New CBD Constructuin Ltd.

Partner Obermeyer Planen und Beraten GmbH, MOD (Shanghai), ECADI (Shanghai)

Planning period 2004-2006

Construction period 2006

Completion 2006

Services Planning management (Lph 1-5,8)

Size 5.5 ha

Costs 17 million € net

Competition 1. Prize, 2004

Images Chen Bing, Sabine Wutzelhofer

POLA

POLA Landschaftsarchitekten GmbH

Neue Schönhauser Str. 16

10178 Berlin

T +49 (0)30-240 00 99-10

F +49 (0)30-240 00 99-11

Hongkongstr. 7

20457 Hamburg

T +49 (0)40-807 92 12-55

F +49 (0)40-807 92 12-15

mail@pola-berlin.de

www.pola-berlin.de

Press enquiries: pr@pola-berlin.de